

**Sandwich pressure regulator with air pilot adjust**

**OPERATIONAL BENEFITS**

1. Easy mounting; saves on installation costs in comparison with inline regulators.
2. Compact all-included units.
3. Large orifice provides high flow.
4. Various functions available.
5. Simple, reliable and solid design.



PR37A  
PR42B  
PR46A  
PR47A  
PR48B

**PR92C**

PR93A

PRA01A

PRA02A

PRA1A

PRP1A

PRA2D

PRP2B

PRA3C

PRP3B

**HOW TO ORDER**

REGULATORS FOR "PLUG-IN" VALVES

Gage	Regulator A end Single pressure	Regulator B end Single pressure	Regulator A * end with by-pass end plate B end	Regulator B * end with by-pass end plate A end	Regulator * both ends
<b>Gage port only (plugged)</b>	PR92C-EAAA	PR92C-EBAA	PR92C-ECAA	PR92C-EDAA	PR92C-EEAA
<b>Gage with face perpendicular to manual operator</b>	PR92C-EABA	PR92C-EBBA	PR92C-ECBA	PR92C-EDBA	PR92C-EEBA
<b>Gage with face parallel to manual operator</b>	PR92C-EACA	PR92C-EBCA	PR92C-ECCA	PR92C-EDCA	PR92C-EECA

Note: above models are coded for use with single solenoid valves

REGULATORS FOR "NON PLUG-IN" VALVES

Gage	Regulator A end Single pressure	Regulator B end Single pressure	Regulator A * end with by-pass end plate B end	Regulator B * end with by-pass end plate A end	Regulator * both ends
<b>Gage port only (plugged)</b>	PR92C-GAAA	PR92C-GBAA	PR92C-GCAA	PR92C-GDAA	PR92C-GEAA
<b>Gage with face perpendicular to manual operator</b>	PR92C-GABA	PR92C-GBBA	PR92C-GCBA	PR92C-GDBA	PR92C-GEBA
<b>Gage with face parallel to manual operator</b>	PR92C-GACA	PR92C-GBCA	PR92C-GCCA	PR92C-GDCA	PR92C-GECA

\* For use with dual pressure valves.

**PLUG-IN OPTIONS**

PR92C-Exxx

F for double solenoid valve

**TECHNICAL DATA**

<b>Fluid :</b>	Compressed air, inert gases
<b>Pressure range :</b>	0 to 120 PSI
<b>Regulating range :</b>	0 to 120 PSI
<b>Lubrication :</b>	Not required, if used select a medium aniline point lubricant (between 180°F to 210°F)
<b>Filtration :</b>	40 μ
<b>Temperature range :</b>	0°F to 120°F (-18°C to +50°C)
<b>Flow :</b>	0.8 C <sub>v</sub>

- Spare parts :
- R-92003 : regulator end plate kit • Gage kit 0 - 160 PSI: N-92006-01
  - R-92003-01 : regulator by-pass end plate kit
  - Pressure regulator (less sandwich block) : PR92C-H0AA

**DIMENSIONS**

Dimensions shown are metric (mm)

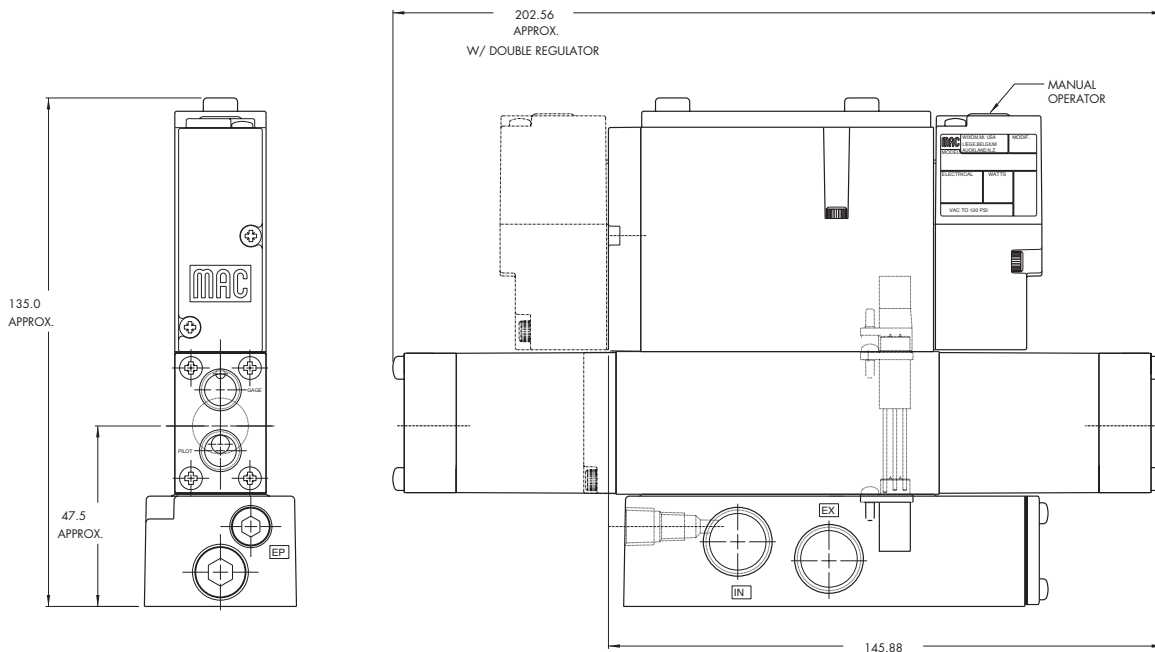

**Sandwich pressure regulator with manual adjust knob**

**OPERATIONAL BENEFITS**

1. Easy mounting; saves on installation costs in comparison with inline regulators.
2. Compact all-included units.
3. Large orifice provides high flow.
4. Various functions available.
5. Simple, reliable and solid design.



PR37A  
PR42B  
PR46A  
PR47A  
PR48B  
**PR92C**

**HOW TO ORDER**

REGULATORS FOR "PLUG-IN" VALVES (CODED FOR KNOB ADJUSTMENT)

Gage	Regulator A end Single pressure	Regulator B end Single pressure	Regulator A * end with by-pass end plate B end	Regulator B * end with by-pass end plate A end	Regulator * both ends
<b>No Gage</b>	PR92C-JAAA	PR92C-JBAA	PR92C-JCAA	PR92C-JDAA	PR92C-JEAA
<b>Gage with face perpendicular to manual operator</b>	PR92C-JABA	PR92C-JBBA	PR92C-JCBA	PR92C-JDBA	PR92C-JEBA
<b>Gage with face parallel to manual operator</b>	PR92C-JACA	PR92C-JBCA	PR92C-JCCA	PR92C-JDCA	PR92C-JECA

PR93A  
PRA01A  
PRA02A

Note: above models are coded for use with single solenoid valves

REGULATORS FOR "NON PLUG-IN" VALVES (CODED FOR KNOB ADJUSTMENT)

Gage	Regulator A end Single pressure	Regulator B end Single pressure	Regulator A * end with by-pass end plate B end	Regulator B * end with by-pass end plate A end	Regulator * both ends
<b>No Gage</b>	PR92C-LAAA	PR92C-LBAA	PR92C-LCAA	PR92C-LDAA	PR92C-LEAA
<b>Gage with face perpendicular to manual operator</b>	PR92C-LABA	PR92C-LBBA	PR92C-LCBA	PR92C-LDBA	PR92C-LEBA
<b>Gage with face parallel to manual operator</b>	PR92C-LACA	PR92C-LBCA	PR92C-LCCA	PR92C-LDCA	PR92C-LECA

PRA1A  
PRP1A  
PRA2D

\* For use with dual pressure valves.

Notes: - Regulating range for above models is 0 to 120 PSI. For other ranges, see technical data page.

**OPTIONS**

Regulator less sandwich block

PR92C-**x0xx**

- M** Knob
- D** Slotted stem
- S** Slotted stem with locknut

Other adjustment

PR92C-**xxxx**

- A** Slotted stem, single solenoid
- B** Slotted stem, double solenoid
- C** Slotted stem, non plug-in
- K** Knob, double solenoid
- N** Slotted stem w/ locknut, single solenoid
- P** Slotted stem w/ locknut, double solenoid
- R** Slotted stem w/ locknut, non plug-in

PRP2B  
PRA3C  
PRP3B

**TECHNICAL DATA**

<b>Fluid :</b>	Compressed air, inert gases
<b>Pressure range :</b>	0 to 120 PSI
<b>Regulating range :</b>	0 to 120 PSI
<b>Lubrication :</b>	Not required, if used select a medium aniline point lubricant (between 180°F to 210°F)
<b>Filtration :</b>	40 μ
<b>Temperature range :</b>	0°F to 120°F (-18°C to +50°C)
<b>Flow :</b>	0.8 C <sub>v</sub>

- Spare parts :
- R-92003 : end plate kit • R-92003-01 : by-pass end plate kit
  - Gage kit 0 – 160 PSI : N-92006-01 • Gage kit 0 – 100 PSI : N-92006-02
  - Gage kit 0 – 60 PSI : N-92006-03

- Options:
- Pressure range: PR92C-xxxA (A 0 to 120 PSI)
    - B 0 to 80 PSI
    - C 0 to 30 PSI
    - D 0 to 120 PSI "A" end, 0 to 80 PSI "B" end
    - E 0 to 120 PSI "B" end, 0 to 80 PSI "A" end
    - F 0 to 120 PSI "A" end, 0 to 30 PSI "B" end
    - G 0 to 120 PSI "B" end, 0 to 30 PSI "A" end
    - H 0 to 80 PSI "A" end, 0 to 30 PSI "B" end
    - J 0 to 80 PSI "B" end, 0 to 30 PSI "A" end

**DIMENSIONS**

Dimensions shown are metric (mm)

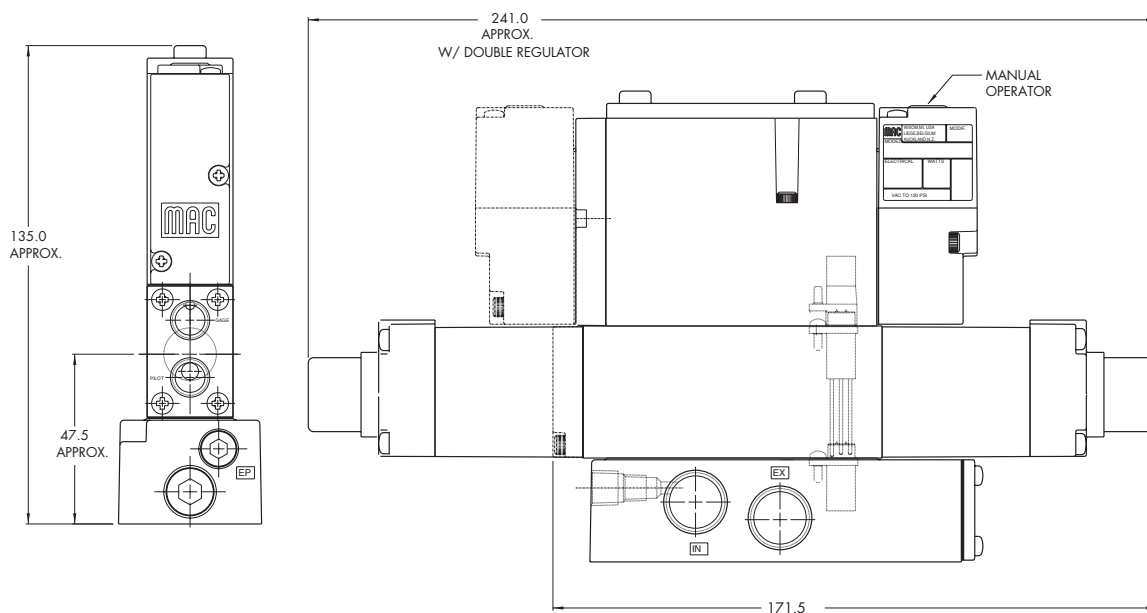

**Sandwich selector pressure regulator with manual adjust knob**

**OPERATIONAL BENEFITS**

1. Easy mounting; saves on installation costs in comparison with inline regulators.
2. Compact all-included units.
3. Large orifice provides high flow.
4. Various functions available.
5. Simple, reliable and solid design.



PR37A  
PR42B  
PR46A  
PR47A  
PR48B

**PR92C**

PR93A

PRA01A

PRA02A

PRA1A

PRP1A

PRA2D

PRP2B

PRA3C

PRP3B

**HOW TO ORDER**

REGULATORS FOR "PLUG-IN" VALVES (CODED FOR KNOB ADJUSTMENT)

Gage	Select to A port Regulator A end By-pass plate B end	Select to B port Regulator B end By-pass plate A end	Select to A port Reg. both ends A end low press. B end high press.	Select to B port Reg. both ends A end high press. B end low press.
No Gage	PR92C-JPAA	PR92C-JRAA	PR92C-JSAA	PR92C-JTAA
Gage with face perpendicular to manual operator	PR92C-JPBA	PR92C-JRBA	PR92C-JSBA	PR92C-JTBA
Gage with face parallel to manual operator	PR92C-JPCA	PR92C-JRCA	PR92C-JSCA	PR92C-JTCA

Note: above models are coded for use with single solenoid valves

REGULATORS FOR "NON PLUG-IN" VALVES (CODED FOR KNOB ADJUSTMENT)

Gage	Select to A port Regulator A end By-pass plate B end	Select to B port Regulator B end By-pass plate A end	Select to A port Reg. both ends A end low press. B end high press.	Select to B port Reg. both ends A end high press. B end low press.
No Gage	PR92C-LPAA	PR92C-LRAA	PR92C-LSAA	PR92C-LTAA
Gage with face perpendicular to manual operator	PR92C-LPBA	PR92C-LRBA	PR92C-LSBA	PR92C-LTBA
Gage with face parallel to manual operator	PR92C-LPCA	PR92C-LRCA	PR92C-LSCA	PR92C-LTCA

Notes: - Regulating range for above models is 0 to 120 PSI. For other ranges, see technical data page  
- Use single pressure valve for all above models.

**OPTIONS**

Regulator less sandwich block

PR92C-x0xx

- M Knob
- D Slotted stem
- S Slotted stem with locknut

Other adjustment

PR92C-xxxx

- A Slotted stem, single solenoid
- B Slotted stem, double solenoid
- C Slotted stem, non plug-in
- K Knob, double solenoid
- N Slotted stem w/ locknut, single solenoid
- P Slotted stem w/ locknut, double solenoid
- R Slotted stem w/ locknut, non plug-in

**TECHNICAL DATA**

<b>Fluid :</b>	Compressed air, inert gases
<b>Pressure range :</b>	0 to 120 PSI
<b>Regulating range :</b>	0 to 120 PSI
<b>Lubrication :</b>	Not required, if used select a medium aniline point lubricant (between 180°F to 210°F)
<b>Filtration :</b>	40 μ
<b>Temperature range :</b>	0°F to 120°F (-18°C to +50°C)
<b>Flow :</b>	0.8 C <sub>v</sub>

- Spare parts :
- R-92003 : end plate kit • R-92003-01 : by-pass end plate kit
  - Gage kit 0 – 160 PSI : N-92006-01 • Gage kit 0 – 100 PSI : N-92006-02
  - Gage kit 0 – 60 PSI : N-92006-03

- Options :
- Pressure range: PR92C-xxxA (A 0 to 120 PSI)
    - B 0 to 80 PSI
    - C 0 to 30 PSI
    - D 0 to 120 PSI "A" end, 0 to 80 PSI "B" end
    - E 0 to 120 PSI "B" end, 0 to 80 PSI "A" end
    - F 0 to 120 PSI "A" end, 0 to 30 PSI "B" end
    - G 0 to 120 PSI "B" end, 0 to 30 PSI "A" end
    - H 0 to 80 PSI "A" end, 0 to 30 PSI "B" end
    - J 0 to 80 PSI "B" end, 0 to 30 PSI "A" end

**DIMENSIONS**

Dimensions shown are metric (mm)

